

Leussink

Think. Solve. Engineer.

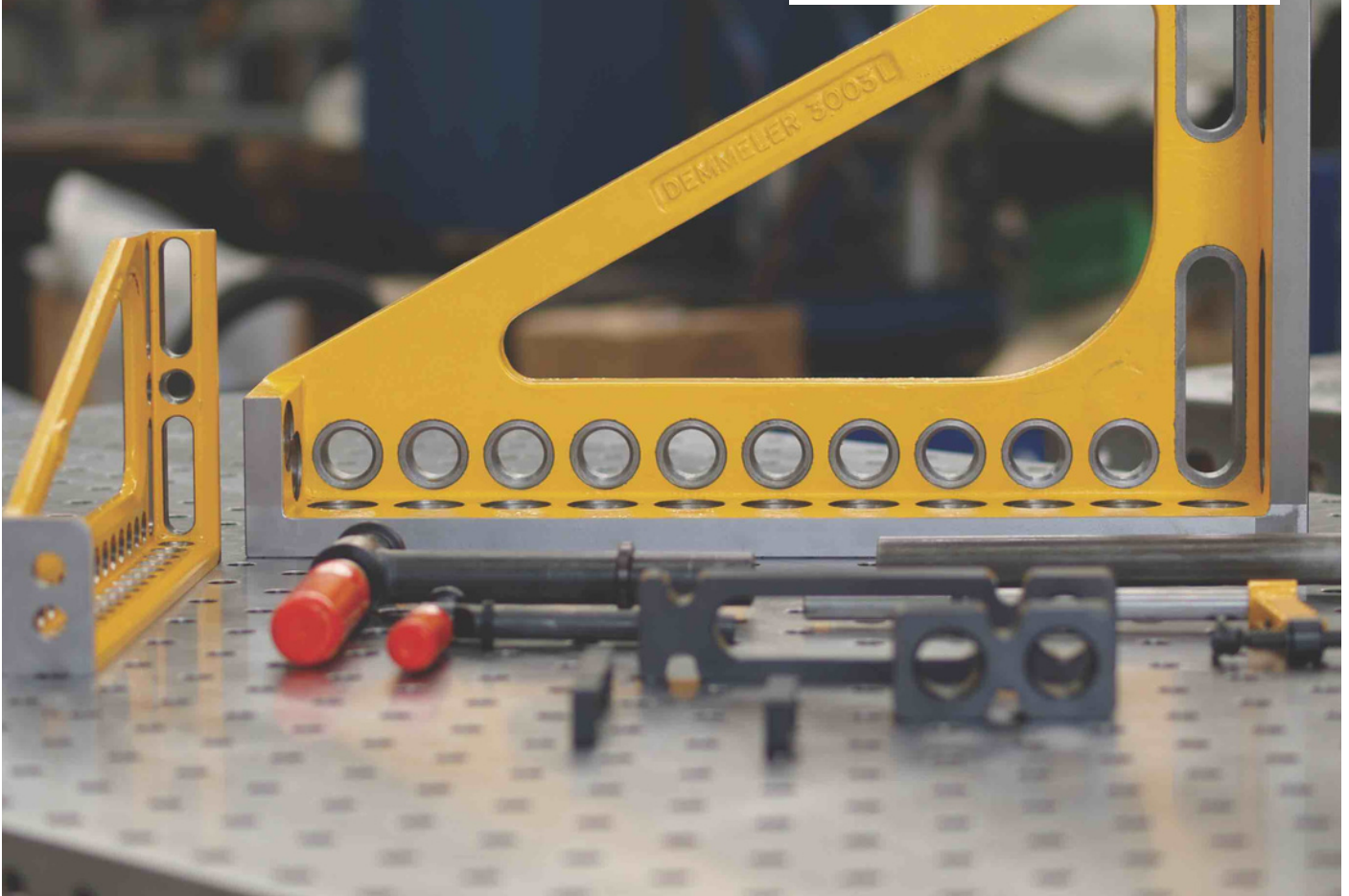

DEMMELE EXPERTLINE SERIES

Welding and Clamping Tables



► About Us

Located in the Illawarra district on the south coast of NSW, Leussink is not just an engineering company; it's an embodiment of relentless pursuit.

As a proud family-owned and operated business, Leussink thrives on embracing new challenges and engineering achievements. For more than 40 years, we've taken on engineering challenges that others might shy away from.

Leussink specialises in providing customised engineering solutions, state-of-the-art modular welding and fixturing systems, foundry equipment, and on-the-go metrology solutions. We've partnered with some of the most iconic businesses in Australia and New Zealand, spanning manufacturing, resource, defense, automotive, and production industries.

Leussink is the exclusive partner and distributor of German-made Demmeler modular fixturing systems in Australia and New Zealand.



We deliver market-leading, world-class Demmeler fixturing tables and accessories for Australian businesses across a variety of industries. Every solution we recommend has been rigorously tested and approved in our own factory.

At Leussink, we don't just sell welding tables; we provide tailor-made fabrication solutions designed to meet your unique business needs.

From system design to after-sales support, implementation, and training, our decades of experience and knowledge empower us to create solutions that boost efficiency, productivity, quality, and precision.

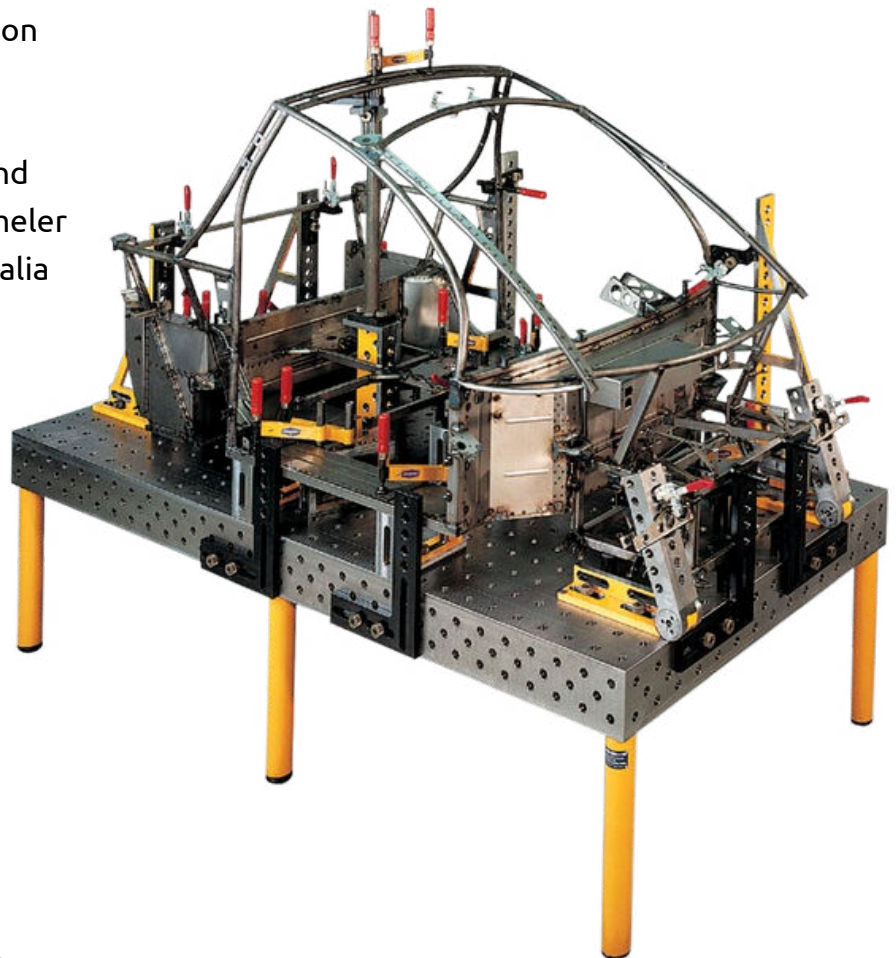

► ExpertLine Welding Tables

The D28 ExpertLine is our preferred system for accurate fixturing.

The D28 ExpertLine system has an extensive clamping product range with a large selection of accessories available.

- Bores Ø 28
- Grid 100 x 100 mm
- Bore spacing 100 mm
- Table side height 223 mm
- Material thickness approx. 25 mm
- For everyday and heavy weldments

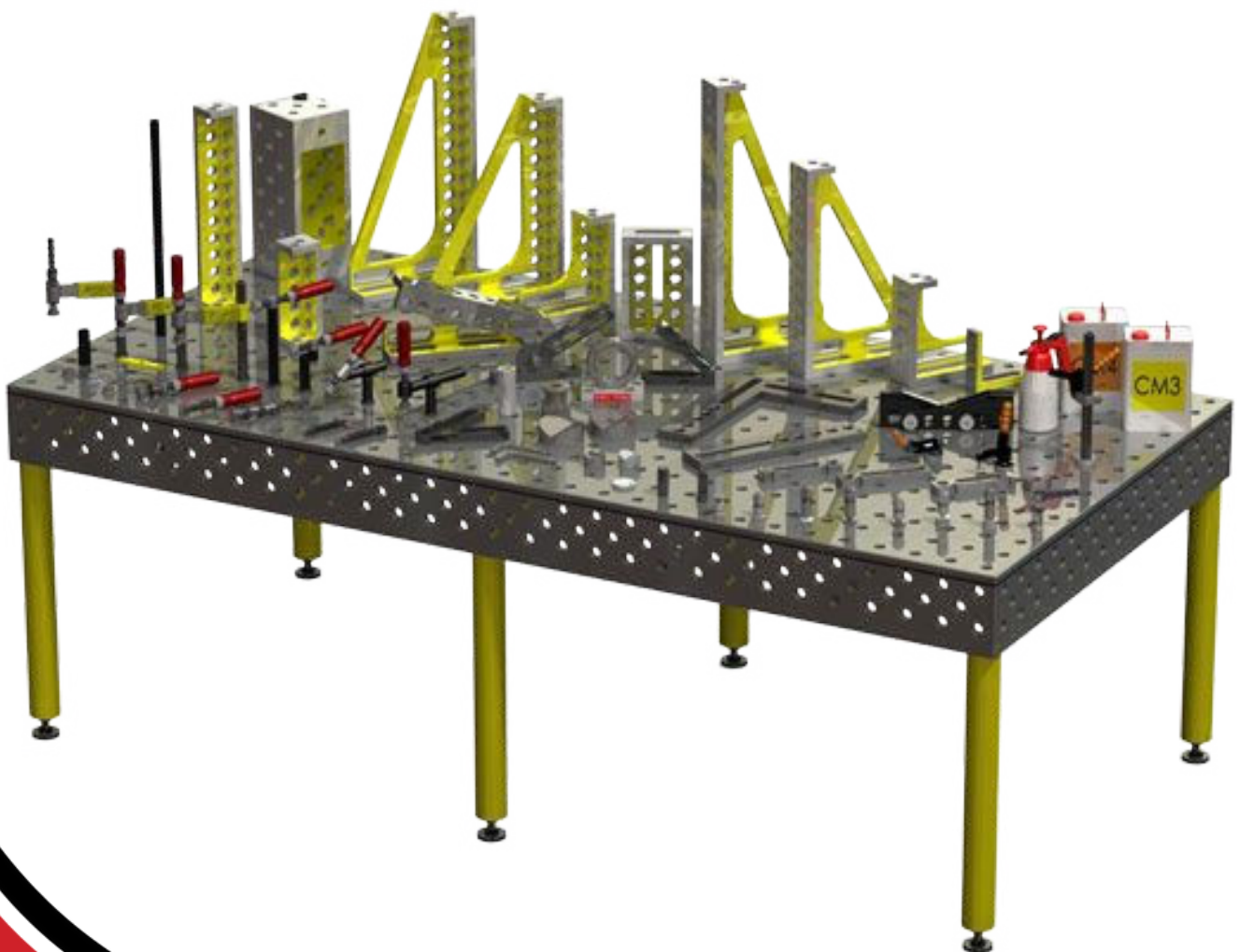

► ExpertLine Welding Tables

Your benefits at a glance

- Standard 4 hole pattern (Optional 5 & 9 Hole)
- Sound technology for everyday use!
- Grid lines every 100 mm
- With high fins and strongly ribbed, hence high intrinsic stability
- Stable M24 x 2 threaded foot spindle ± 30 mm adjustable
- Modularly expandable in all five directions over the entire length, width and height
- Without measuring rule, it is possible to very quickly erect accurate clamping jigs
- Various foot type versions available
- Spatter free with use of ProtectDem solution
- High precision tolerancing

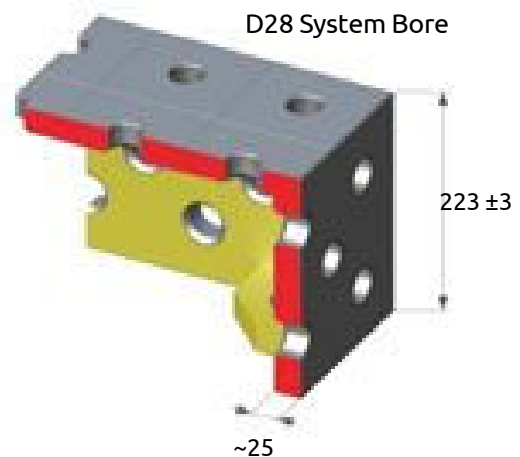
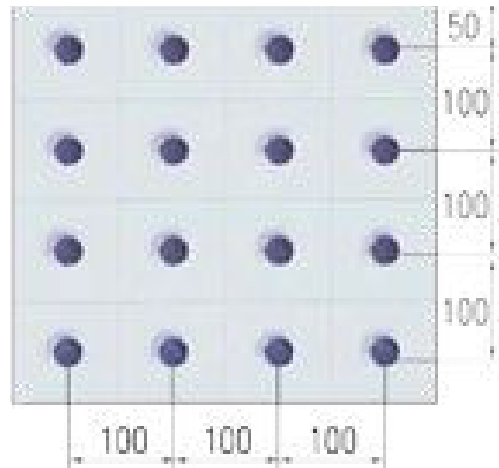

"SMART" car prototype fixtured on a 1500 x 3000 table with standard components.

► ExpertLine Welding Tables

Worktables

Description	L (mm)	W (mm)	H (mm)	Kg	Legs	Item Code
1000 x 1000 3D Demmeler Worktable	1000	1000	220	368	4	1001
1200 x 1200 3D Demmeler Worktable	1200	1200	220	474	4	1001-2
1500 x 1500 3D Demmeler Worktable	1500	1500	220	724	4	1001-25
2000 x 1000 3D Demmeler Worktable	2000	1000	220	656	4	1002
2400 x 1200 3D Demmeler Worktable	2400	1200	220	914	6	1003
3000 x 1500 3D Demmeler Worktable	3000	1500	220	1420	6	1004

Legs

Description	Adjustment	H (mm)	Kg	Item Code
Assy 3D Table Leg	± 30mm	630	9	1009-3D

Note:

1. Special sizes available on request.
2. Table item codes shown do not include legs.

► D28 & D16 systems for everyday weldments

Demmeler Accessories



Your benefits:

1. Double hex key drive for maximum accessibility
2. Knurled bolt head for fast one-hand operation
3. Large clamp range, 5t clamp force, 25t shear force
4. High quality hardened steel for high precision ground finish
5. Double O-Rings to stop simultaneous rotation when tightening and cleaning the system bores.
6. 5 clamping balls mechanically secured against falling out
7. Ergonomic design allowing for multi-bolt corner interaction
8. Plus lifetime warranty!



Your benefits:

1. Workpiece clamping true to position and location with adjustable spring loaded compensation
2. Tension tube replaced quickly, available in different lengths
3. With adjustment ring for height fixing
4. Handle type can be changed, e.g. Hex, Tee, Toggle or pneumatic cylinder.
5. Foot pad can be exchanged. e.g. Stainless Steel, Plastic or Steel
6. Suitable with any Demmeler system bore (self-clamping effect)
7. Modular in construction
8. Extendable, Retractable, 2 Position Clamping Range
9. Plus lifetime warranty!



Your benefits:

1. Bessey handle with a special surface and rubberised inserts for rich and non-slip grip!
2. Additional handle types can be exchanged, e.g. Hex, Tee, Toggle or Pneumatic cylinder
3. Modularity down to detail: The Demmeler clamping bush can be used in any system bore. This allows for multiple clamping options in a few simple steps!
4. Clamping handle can be tilted up to 15° at full power allowing enough room for welding!
5. Foot pad can be exchanged and also be used in system
6. bores as workpiece support, workpiece stop or small "V" block
Graphite impregnated spindle for maintenance free durability



► **THINK. SOLVE. ENGINEER.**

Leussink is a solutions-focused engineering company based on the East Coast of Australia. For over 45 years, Leussink has been tackling problems that other businesses deem too difficult.

Our dedication to providing best-fit solutions in short time frames has afforded us the opportunity to work with some of Australia's and New Zealand's most iconic manufacturing, resource and production companies. Proudly family-owned and operated, Leussink is unwavering in our pursuit of new challenges and engineering achievements.

Contact us today to find out how Leussink can help you maximise your productivity and accuracy.

Leussink Engineering

ABN 64 074 228 005

16 - 18 Doyle Ave, UNANDERRA NSW 2526

P +61 2 4260 7777 E info@leussink.com.au leussink.com.au

Leussink

Think. Solve. Engineer.